



Longstanton & District Heritage Society

Protecting and Promoting
the Heritage of
Longstanton & District

NEWSLETTER

No. 12 September 2019

Heritage Annex Update

Artist Impression of what the Northstowe Heritage Annex could look like

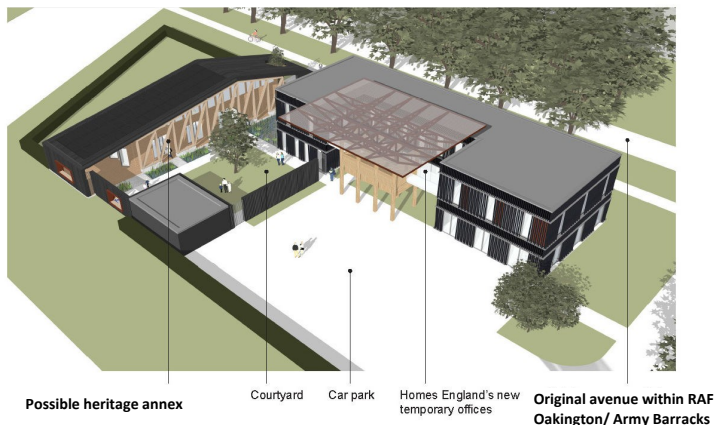

LDHS continues to work with Homes England, Cambridgeshire County Council and others on a possible scheme to provide a heritage annex on Northstowe Phase 2. This facility would provide a hub where the heritage of the existing villages and Northstowe can be preserved via displays, stories and a plethora of other ways in order to engage the interest and imagination of school children, residents and visitors to the new town and the surrounding area.

Memorandum of Understanding

A Memorandum of Understanding has been agreed between CCC, Homes England and LDHS illustrating a willingness by all parties to work together to promote the heritage of Longstanton, Northstowe and the wider area. Work continues to move this project forward and we will update members as soon as further information becomes available.



Members of the LDHS committee were delighted to receive an invitation to tour the Homes England office site in May. We continue discussions with Homes England and others, to explore ways in which the heritage of the Northstowe site (formerly part of Longstanton and Oakington & Westwick parishes) can be displayed in this new building and in other locations across our communities.

6 June 2019, 75 Anniversary of the D Day Landings by Carl Lightfoot

The 1st Battalion The Royal Anglian Regiment (The Vikings) was based at Oakington Barracks from 1982-84 and 1996-99.

The Battalion is an amalgamation of The Royal Norfolk Regiment, the 1 Suffolk Regiment, the Essex Regiment and lastly the Cambridgeshire Regiment.

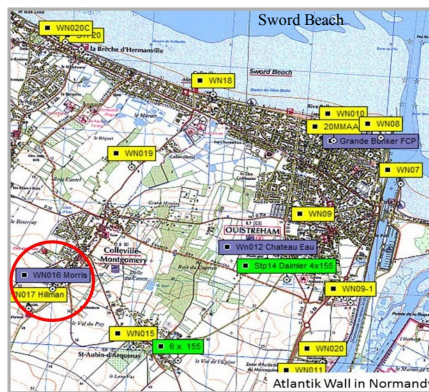

Objective **HILLMAN** was just over 2 miles in land from **SWORD** Beach

The Royal Norfolk Regiment and 1 Suffolk (both infantry battalions) landed on the **SWORD** beach on D-Day.

The Royal Norfolk



Road to Caen – a tailback of troops from **185 Infantry Brigade** marks the beginning of the controversial advance towards the

Regiment was a part of **185 Infantry Brigade** and 1 Suffolk was a part of 8 Infantry Brigade. Both brigades were part of the 3rd Division (the Iron Division) commanded by General Montgomery. The men of the 1 Norfolks, part of **185 Infantry Brigade**, had key roles in the boldly conceived plan to capture the city of Caen. Following the initial landings, the Suffolks were to push on and capture two German strongpoints, part of Hitler's Atlantic Wall, (WN016 known as **MORRIS** and WN017 known as **HILLMAN** - all the German positions in the **SWORD** Beach area were named after various makes of British car) - allowing a tank-supported infantry brigade, which included the Norfolks, to make a dash for Caen...

The above is a summary of information provided to LDHS by Carl Lightfoot. This formed part of the Society's contribution towards an exhibition commemorating the 75th Anniversary of the D-Day landings, held at St Michael's church and organised by the Friends of St Michael's Group.

Hatton Park School Test Pit Weekend



Organised by LDHS, in association with the Fen Edge Archaeology Group (FEAG), Longstanton and Northstowe residents have been invited to participate in an archaeological test pitting event over the weekend of 28th/29th September on the playing field at Hatton Park School, Longstanton. The school is on the site of the Mansion House of the Hatton family which replaced an earlier



Aerial view of the Hatton Park School playing field, 2019

Medieval manor. This in turn, may have been sited on or near the manorial heart of the original Anglo-Saxon village. For centuries, the Lords of Longstanton's manors were the largest land owners in the parish: the Hatton Estate totalling approximately 1700 acres, when it was eventually broken up

and sold off in the latter half of the 19th Century. The Longstanton manors covered land that remains within Longstanton village as well as land that is now destined to be part of Northstowe. For this reason this test-pitting project will be of interest to both communities and is yet another illustration of our inseparable historical past. Our thanks go to the school's Head Teacher for his enthusiastic support of the project. This event follows on from two previous test pitting projects that LDHS helped to organise in 2015 and 2017.

Longstanton Ponds

In June, our Secretary was contacted by a village resident expressing concern for the historic pond that lies within Ladywalk. In view of our previous work we have pressed the Parish Council to investigate what can be done in this case.



Ladywalk pond in Oct 2013 - water level good, it's been home for ducks for years

LDHS comment: Landscape features are part of the heritage that LDHS is obliged to try to protect. As in previous years, we will continue to highlight concerns in the hope that action will be taken to rectify this environmental crisis.



Ladywalk pond in Oct 2019 - water all but gone, choked by sedge and rushes

LDHS Public Talks Autumn 2018

September, 'The Brontes', Dr Gordon Hewlett'

October, 'Cambridge's Influence on Football/ Cricket', Nigel Fenner

November, 'The Pye Years', Roger Crabtree

Record of LDHS Public Talks Spring 2019

March 'On Going Discoveries at Northstowe Ph 2' Alison Dickens

April 'The History of Heffers' Julie Bounford

May 'Oakington Barracks' Carl Lightfoot

Forthcoming Public Talks Autumn 2019

Friday 6 September, AGM followed by, 'Cambridge at War 1914-18', Mike Petty

Friday 4 October 'Northstowe: Learning lessons from previous New Towns', Ian Hunter

Friday 1 November 'Digging Up a Spitfire', James Fairburn



Northstowe Secondary College Opens

September 2019, will see the first intake of pupils into the new Northstowe Secondary College which has been built on the former site of RAF Oakington (Phase 2). Approximately half of this single year intake will come from the Longstanton school whilst the remainder will come from the wider area. In total it is estimated that 70 pupils will be starting school at the secondary college this Autumn, representing another historic milestone in the birth of this new town. LDHS has welcomed the communications we have already had with the Head of School and look forward to supporting the school in its development of local history provision so the pupils can understand the history of the school site and the origins of the new town.



Construction of the Secondary College and SEN School on Phase 2. Photo by AP Aerial Film, 2019

The Year Ahead

LDHS will continue to fulfil the obligations conferred on us by our Constitution. We will continue our work to try and achieve a heritage facility out on the former site of RAF Oakington. In addition, part of our work over the forthcoming year will be to seek guidance from CCC and others to try and ensure that our administration, our archival procedures and our governance are robust enough to ensure we provide good care of the archives and make progress towards securing their long term future.

Longstanton & District Heritage Society

The Manor, Woodside, Longstanton, Cambridge. CB24 3BU

Tel. 01954 782560. e-mail: ldhssec@hotmail.co.uk

Website: www.ldhs.org or find us on Facebook

Many thanks to all our members - your membership is our mandate and every single member is invaluable. Remember, please do not hesitate to contact us at any time if you have any queries, would like any information or would like to contribute memories, photographs etc. Contact details are above.